

Series: Blue Ridge MAX
Model: 1B1006-R Breckenridge Max
28



About This Model

Style: Ranch / Bedrooms: 3 / Bathrooms: 2 / Square Feet: 1749

CUSTOMER CONTACT

Notes:

Floorplan

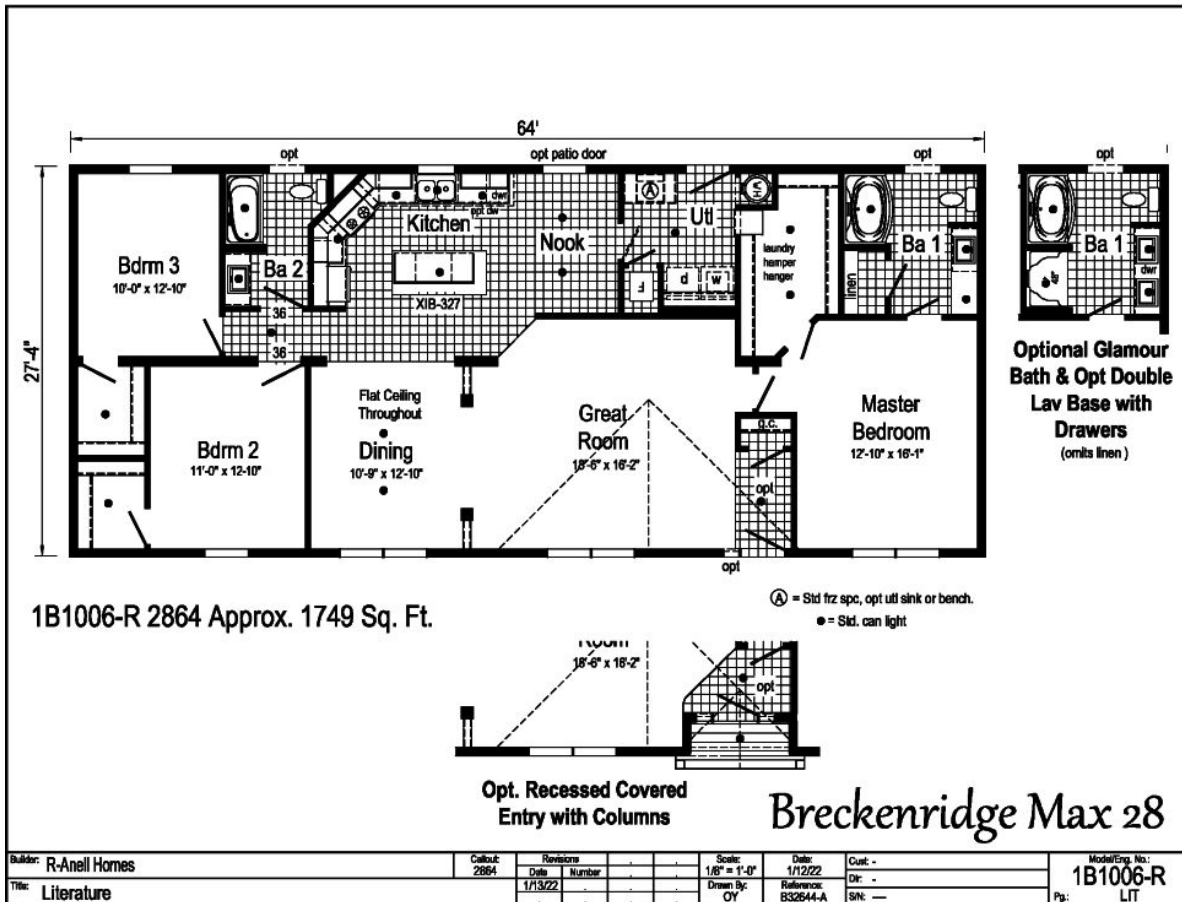

CUSTOMER CONTACT

Notes: _____

Standards & Features

INTERIOR

Primed Smooth Drywall Throughout
 Flat Ceiling Throughout
 Smooth Ceiling
 8'-0" Ceiling Height
 Take Away Carpet Protected with Shaw
 Stain Safety
 5# Carpet Pad
 Tackstrip Carpet Installation
 No-Wax Vinyl Floor Coverings by
 Congoleum
 Recessed 6" LED Lighting
 6-Panel Pre-Hung Doors
 Mortise Door Hinges
 Metal Interior Passage Sets
 Door Stops
 Smoke Detectors with Battery
 Back-Up
 Wire Shelving in Guest Closet &
 Utility Room
 2 1/4" Window & Door Trim
 White Painted Mouldings Throughout
 Laminate Countertops with Laminate Edging
 4" Laminate Backsplash

KITCHEN

Stainless Steel 33x19x7 Sink
 Brushed Nickel Single Lever Faucet
 USB II Receptacle
 18 CF Refrigerator
 Deluxe Free Standing Electric Range

CABINETRY

Evermore Custom Cabinetry
 (KCMA Certified)
 Hardwood Mission Cabinet Doors w/
 Full Overlay
 Hardwood Cabinet Face Frames & Stiles
 Brushed Nickel Cabinet Hardware
 Concealed Cabinet Hinges
 Soft Close Cabinet Doors
 Dovetail Drawers w/ Soft Close Guides
 36" Wall Cabinets with Crouse Crown to
 8'-0" Ceiling Height
 Adjustable Shelves in Wall Cabinets
 Adjustable Center Shelf in Base Cabinets
 Standard Islands in Most Models
 Base Shelf in Vanities
 36" High Vanities

BEDROOMS

Switched Receptacles
 Egress Window Each Bedroom
 Wire Shelves in all Closets
 30" Interior Passage Doors
 Recessed 4" LED Light in All Walk-In Closets
 Privacy Sets in all Bedrooms

BATHS

60" x 42" Fiberglass Garden Tub w/
 Curved Front and Full Surround in Bath 1
 60" One-Piece Fiberglass Tub/Shower
 in 2nd Bath
 One-Piece Fiberglass Shower with
 Glass Door in Glamour Baths

CUSTOMER CONTACT

Notes:

Standards & Features (continued)

BATHS (continued)

Tub Overflows
 1.6 Gallon Per Flush Elongated Toilets
 China Stool, Tank ,and Lid
 w/ soft close seats
 Square China Sinks with Overflows and
 Pop-Up Drains
 Lighted Vent Fan in Each Bath
 LED Lights over Vanities
 Brushed Nickel Faucets
 Anti-Scald Valves on Showers
 Privacy Sets in all Bathrooms
 In-Wall Toilet Riser

UTILITIES

200 AMP Electrical Service
 Arc Fault Circuit Breakers
 Plumb and Wire for Washer
 Wire and Vent for Dryer
 40 Gallon Electric Water Heater with Pan
 6-Panel Furnace Door
 Air Ready Electric Furnace w/Coil Cabinet
 Fiberglass Heat Ducts
 Copper Wiring Throughout
 Main Water Line Shut-Off Valve
 Water Shut-Off Valves -Where Accessible
 One Exterior Water Faucet
 Uponor Plumbing System
 Recessed Dryer Vent Box - Where Available
 Drain Lines Stubbed Through Floor
 Complete Heat System
 Insulated Hot Water Lines and P-Traps

INSULATION

R-30 Fiberglass Insulation in Floor
 R-19 Fiberglass Insulation in Walls
 R-38 Avg. Blown Insulation in Ceiling

EXTERIOR

Gatsby Light at Front and Rear Door
 Two GFI-Protected Exterior
 Receptacles
 Vinyl Dutch Lap Siding
 O.S.B. Sheathing Under Siding
 5/12 Roof Pitch
 10" or 12" Overhangs & Eaves
 (Depending on Model)
 Architectural Shingles, 30 Year
 Ridgevent Roof Ventilation System
 36" Fiberglass 6-Panel Front & Rear
 Doors with Deadbolt Locks
 Vinyl Insulated Windows with
 Low-E Glass
 15" Raised Panel Shutters on Front
 Door Side
 Wind Wrap
 Vapor Barrier

CONSTRUCTION

2x10 Floor System with
 3/4" T&G O.S.B. Floor Decking
 2x6 Exterior Walls
 2x4 Marriage Walls
 20# Roof Load Design
 82 1/2" Window Headers
 90 Mile Exposure B Wind Load Design

CUSTOMER CONTACT

Notes:



PRINTABLE INFO SHEET

Series: Blue Ridge MAX
Model: 1B1006-R Breckenridge Max
28



Standards & Features (continued)

CONSTRUCTION (continued) (TN)

115 Mile Exposure B Wind Load Design
(NC-SC-VA-WV)

**NOTE: Spacing for Framing Members may vary due to
Design Requirements

CUSTOMER CONTACT

Notes:
