

Note: Window fall protection must be provided on-site where required in accordance with applicable section of the IRC.

NOTES: 30' 9/12 cape

Proposed Second Floor:
All design materials and work to be the responsibility of the builders on site to local codes. Light, vent, egress, heating and plumbing are the responsibility of the builder.

Note: Window fall protection must be provided on-site in accordance with section R312 of the 2015 IRC as required.

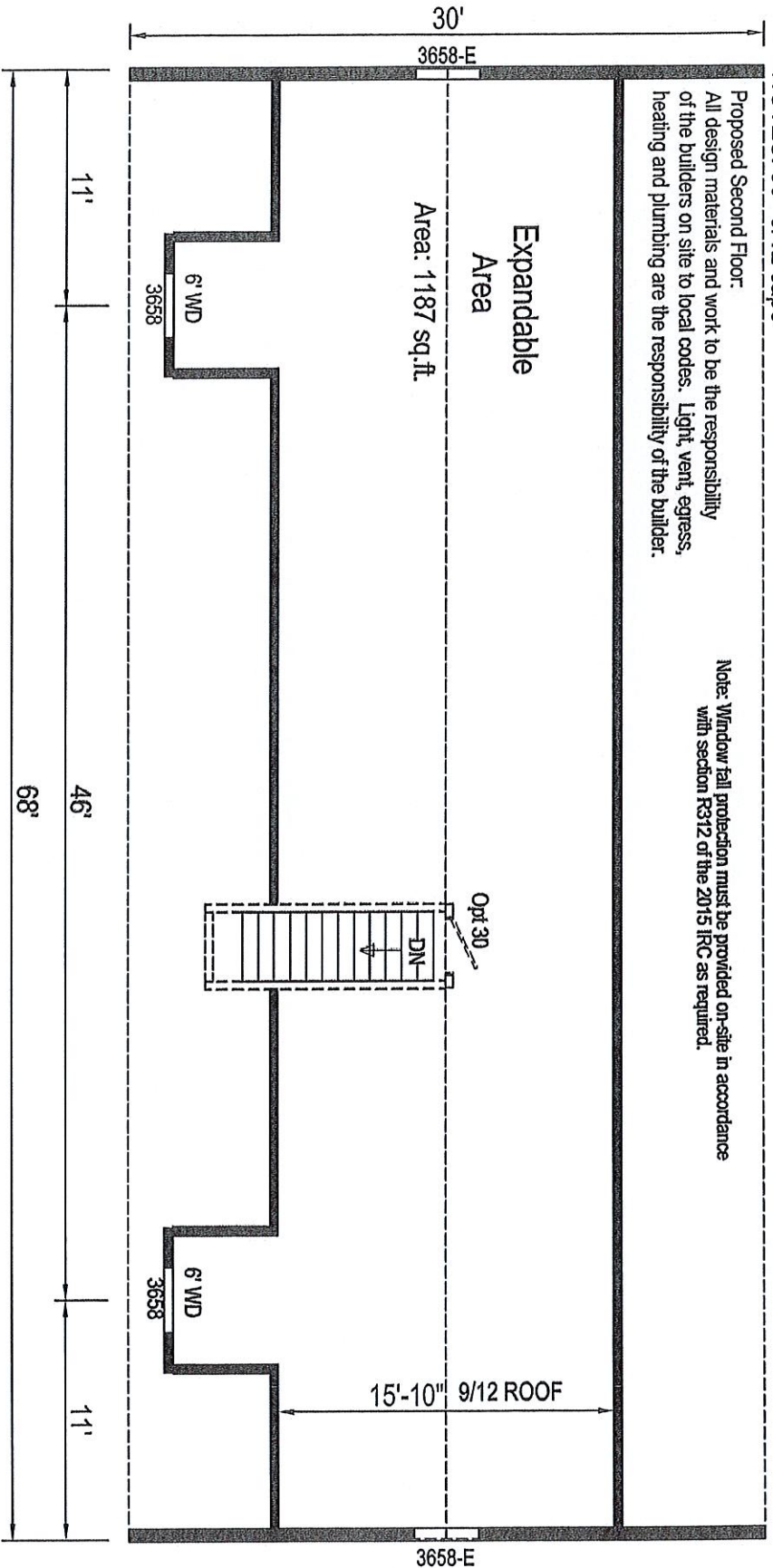

Proposed Second Floor:
All design materials and work to be the responsibility of the builders on site to local codes. Light, vent, egress, heating and plumbing are the responsibility of the builder.
Area: 1187 sq. ft.

Engineer seal applies ONLY to FACTORY MANUFACTURED portions of the building. Seal does not apply to site installed elements or portions built on site such as, but not limited to: foundation, connections to foundation, exterior steps, or other site works. Site work must be designed BY OTHERS for site conditions, under local jurisdiction. COMPLIANCE WITH ALL APPLICABLE CODES PER LOCAL AUTHORITY HAVING JURISDICTION, WHETHER DETAILED IN THIS SET OR NOT, MUST BE MET.

Builder: RAnell Housing Group, LLC - Subsidiary of The Commodore Corp.	Callout: 3268	Revisions:	Scale: 1/8" = 1'-0"	Date: 1/11/14Z018	Cust: Beacham	Model/Eng. No.: RJ-CT-281
Title: Proposed Cape Floor Plan		Number:	Drawn By: SG	Reference: NONE	Dir: NC Custom Modular	Pg.: PCFP